

Recipio '14

TABLES

2014

Antonio Citterio



Description

A contemporary reinterpretation of the classic refectory table, Recipio '14 is a rectangular wooden dining table. The top stands out for its slatted motif, while the crosspiece placed at the base is covered with a steel profile having a dual, aesthetic and protective function. The Recipio series also includes small tables, consoles and a writing desks.

Technical information

Top

solid wood, veneered plywood panel with honeycomb-core and wood particles

Frame

solid wood

Crosspiece protection

aluminium profile

Ferrules

felt

Technical drawings

LXC11

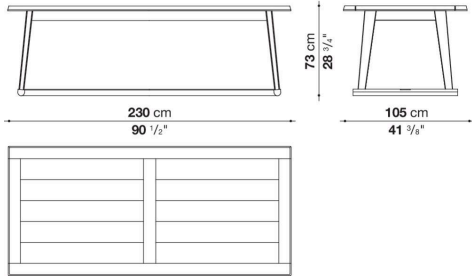

LXC13

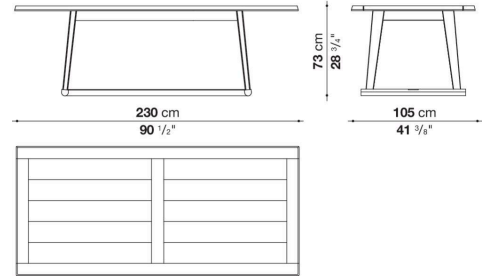

LXC12

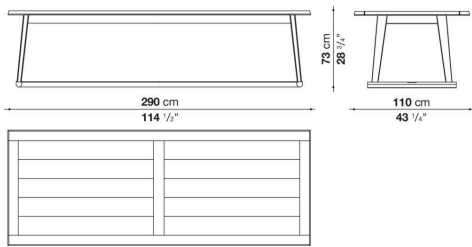

LXC14

